

CSS-R16

Web based RFID & PIN Controller



Time attendance



Access control



Contactless verify



Mobile NFC/ BLE



- Log data real time PUSH
- RFID card + Password + BLE/ NFC verification
- Standalone with build in WebServer
- Simplified installation with Cat-5e cable
- Assign IP camera for capturing snapshot
- WG/ OSDP/ TCP/IP connection
- Built-in Watchdog

Specifications

GENERAL DATA

| | |
|------------------------------|---|
| Verification Mode | Card /PIN /Card + PIN /Mobile APP |
| Software Application | SoMac /Browser |
| Proximity | EM /Mifare /Desfire /HID /BLE /NFC |
| Transmit Frequency | 125KHz/13.56MHz/2.4GHz |
| Host Communication | TCP/IP(10/100M Based)/Http Web Management |
| Reader Communication | WG/OSDP V1/V2 reader |
| 13.56 MHz Compatibility | ISO14443A CSN, ISO14443B CSN, ISO15693 CSN, Desfire EV1/EV2 Sector, NFC-enabled Mobile device |
| Card Capacity | 20,000 |
| System Log | 2,688 |
| Entry Log | 45,000 |
| Time Set /Time Zone /Group | 255 /120 /255 Sets |
| Remote Control /Event Handle | Yes /Yes (with BF-50) |
| Anti Pass Back /Anti Duress | Yes /Yes |

| | |
|-----------------------|--------------------------------------|
| Touch Keypad | Yes |
| LED Indicators | 1-LED with Triple Colors (R / G / B) |
| IP | Static IP /DHCP |
| Built-in Relay | 1 relay (COM/NO/NC)for door lock |
| Buzzer | Single Tone |
| Capacitive Touch Keys | 2 x 6 |

COMMUNICATION DATA

| | |
|----------------|------------------------------------|
| Communications | TCP/IP, Wiegand Input /RS485 /OSDP |
| Wiegand | 1 channel |
| Wiegand Input | 26 /34 /66 bits |

ELECTRICAL DATA & CONDITIONS

| | |
|-----------------------|------------|
| Power Requirement | 9~24VDC/1A |
| Power Consumption | 300mA ± 5% |
| Operation Temperature | 0°C ~ 55°C |
| Operation Humidity | 5%~80% RH |
| Waterproof | IP54 |

PHYSICAL DATA

| | |
|-----------|------------------|
| Dimension | 160 x 57 x 28 mm |
|-----------|------------------|

Structure

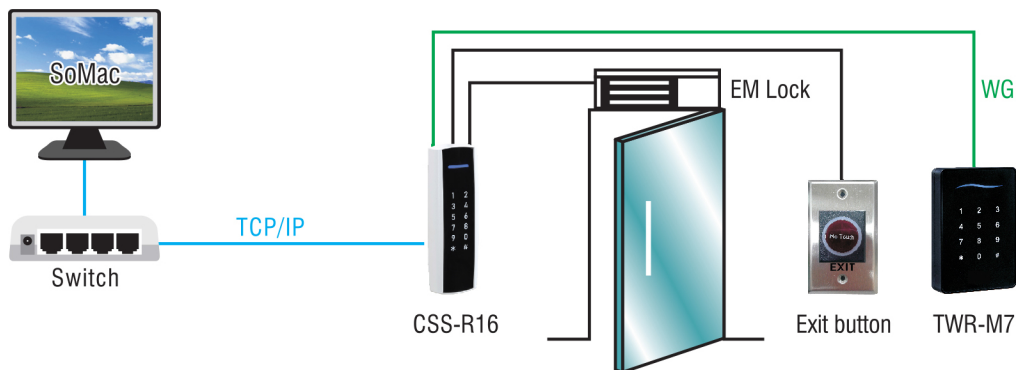

(Security Relay box)

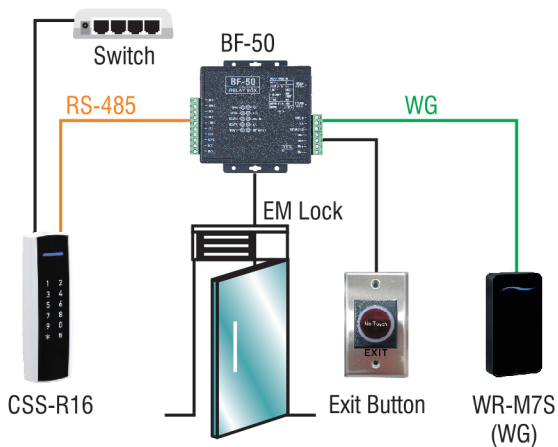

(OSDP server mode)

